

DRAWING SERVICE:
 PROJECT NO. 23021
 DATE 01/18/2018
 TIME 10:00 AM
 (334) 733-8278
 (334) 733-8279
 (334) 714-2340

OWNER:
 JOSH and ALLYSON EDWARDS
 2782 WILLIE VARNUM
 DOTHAN, ALABAMA 36301
 (334) 701-0644
 HER CELL NO. (334) 797-6279

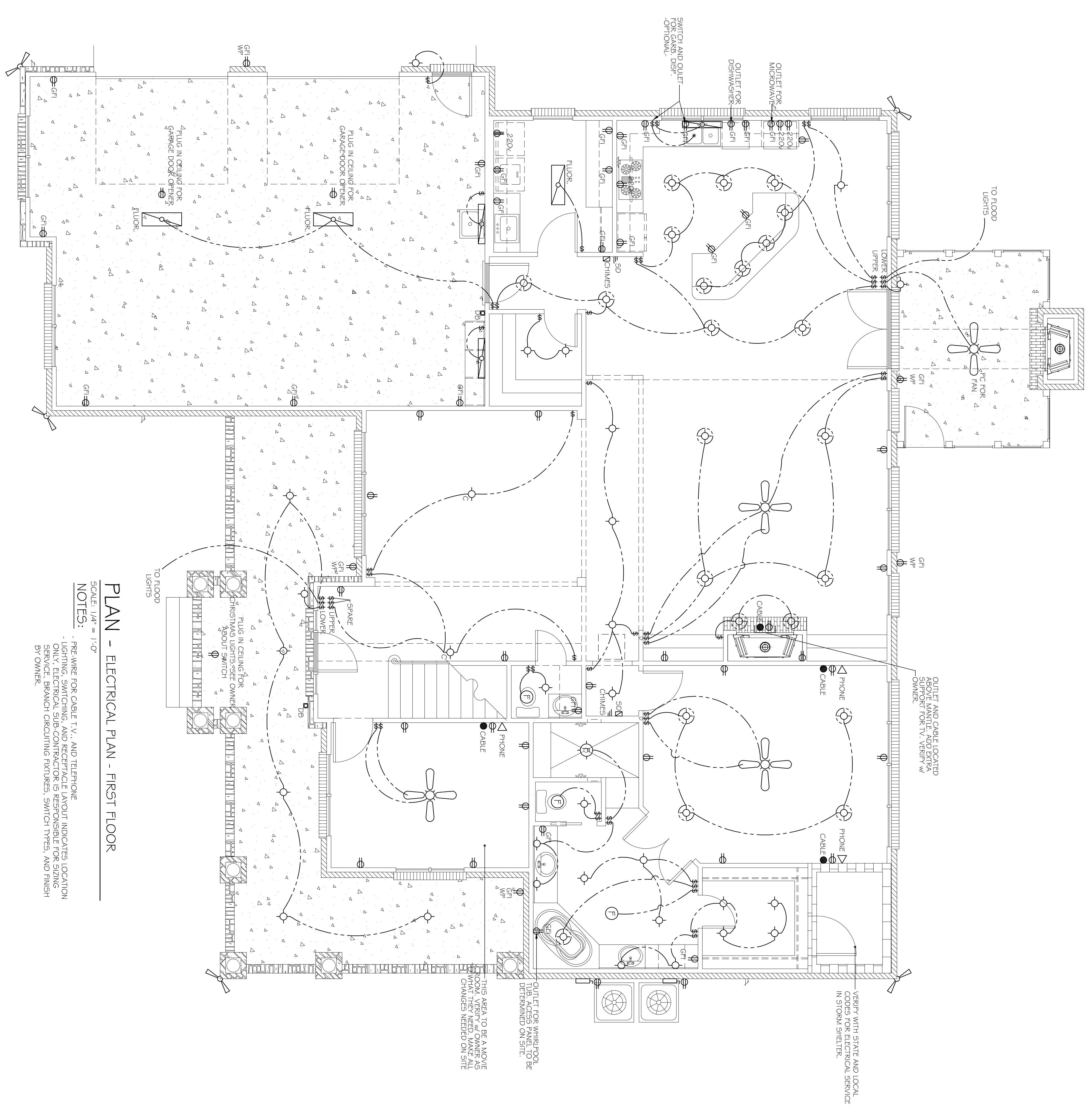

PLAN - ELECTRICAL PLAN - FIRST FLOOR

SCALE: 1/4" = 1'-0"
 NOTES:
 1. PREPARE FOR CABLE TV, AND TELEPHONE
 2. IDENTIFY ALL ELECTRICAL OUTLET INDICATES LOCATION
 3. ONLY ELECTRICAL SUB-CONTRACTOR IS RESPONSIBLE FOR SIZING
 SERVICE, BRANCH CIRCUITING FIXTURES, SWITCH TYPES, AND FINISH
 BY OWNER.

ELECTRICAL LEGEND

▽	- TELEPHONE JACK	⊕	- INCANDESCENT (HANGING)	⊕	- SWITCH SINGLE POLE
●	- CABLE JACK	⊕	- INCANDESCENT (RECESSED)	⊕	- SWITCH W/ DIMMER
○	- CAT 5 OUTLET	⊕	- VENT	⊕	- FAN WITHOUT LIGHT
⊕	- SPARKER OUTLET	⊕	- VENT W/ LIGHT	⊕	- FAN WITH LIGHT
⊕	- 110V DUPLEX	⊕	- 24" FLUORESCENT STRIP		
⊕	- 110V DUPLEX (KITCHEN/BEDROOM)	⊕	- UNDER COUNTER LIGHTS		
⊕	- 110V (GROUND FAULT INTERRUPT)	⊕	- MOTION DETECTOR		
⊕	- 220V DUPLEX	⊕	- DISCONNECT (AMP AS REQ'D)		
⊕	- INCANDESCENT (PICTURE)				
⊕	- GAS FIXTURE				

ELECTRICAL PLAN - FIRST FLOOR
 SHEET NO. 01/18/2018
 DATE 01/18/2018
 TIME 10:00 AM
 (334) 733-8278
 (334) 733-8279
 (334) 714-2340

A NEW RESIDENCE FOR
JOSH and ALLYSON EDWARDS
 2782 WILLIE VARNUM
 DOTHAN, ALABAMA 36301

OWNER:
 JOSH and ALLYSON EDWARDS
 2782 WILLIE VARNUM
 DOTHAN, ALABAMA 36301
 (334) 701-0644
 HER CELL NO. (334) 797-6279