

NOTE:
 1. FIRST FLOOR
 9'-0" CEILING HEIGHT
 UNLESS OTHERWISE NOTED

NOTE:
 BUILDER AND OWNER TO VERIFY
 DIMENSIONS, NOTES AND ALL CONDITIONS
 OF PLANS PRIOR TO CONSTRUCTION.
 PLAN SERVICE IS NOT RESPONSIBLE
 FOR ERRORS OR OMISSIONS.

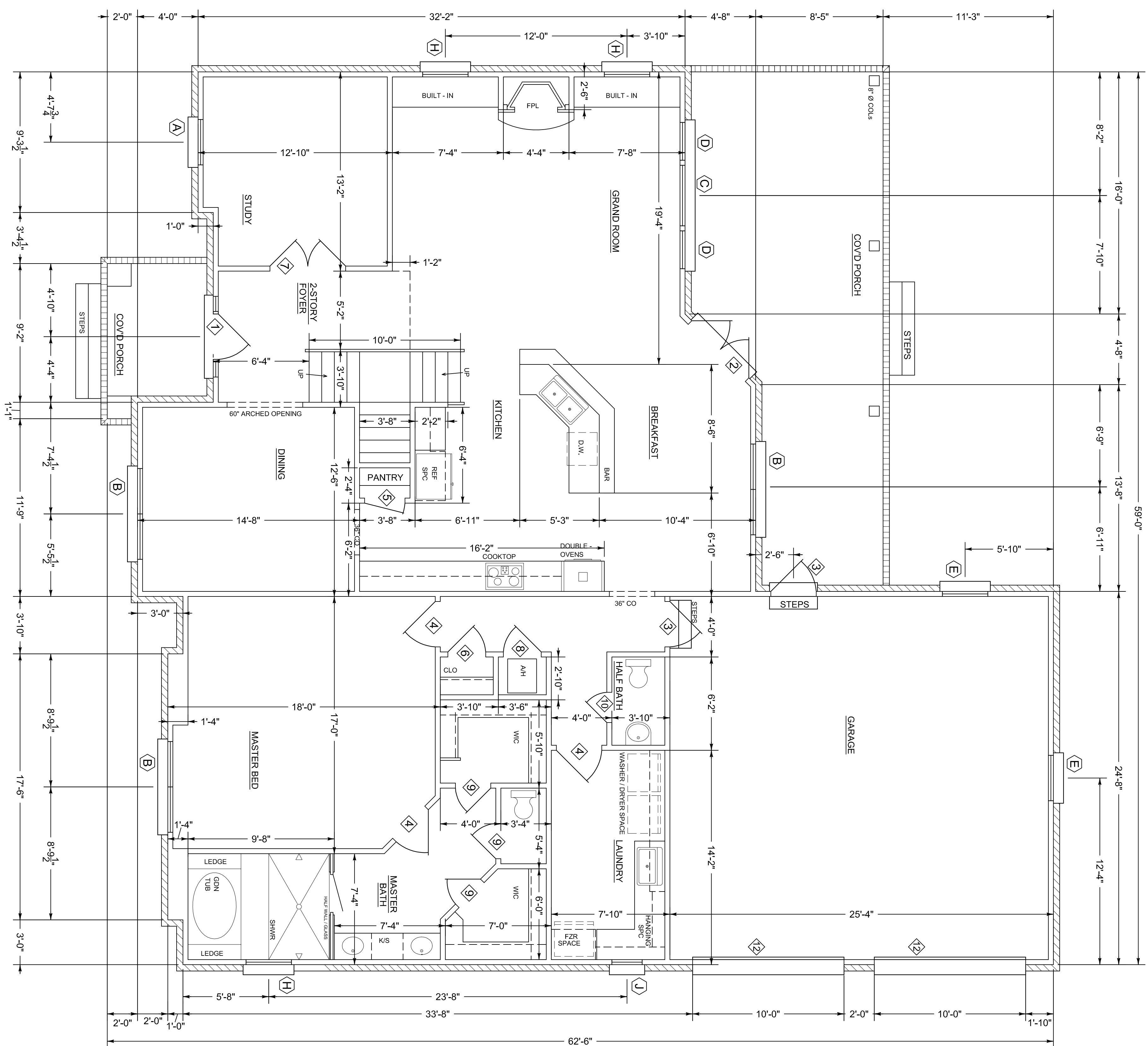

SQUARE FOOTAGE
 FIRST FLOOR HEATED: 2102
 SECOND FLOOR HEATED: 1231
 GARAGE: 654
 PORCHES: 444
 TOTAL: 4431

FIRST FLOOR PLAN
 SCALE 1/4" = 1'-0"

DOOR SCHEDULE			
MARK	SIZE	TYPE	REMARKS
◇	3'-0" x 6'-8" x 1 3/4	WHITE EDGED LITES & TRANSOM	EXTERIOR METAL INSUL.
◇	(2) 2'-8" x 6'-5" x 1 3/4	FRENCH	" " "
◇	3'-0" x 6'-5" x 1 3/4	SIX PANEL	" " "
◇	3'-0" x 6'-5" x 1 3/8	SIX PANEL	INTERIOR MASONITE
◇	2'-8" x 6'-5" x 1 3/8	" "	" "
◇	2'-6" x 6'-5" x 1 3/8	" "	" "
◇	(2) 2'-6" x 6'-5" x 1 3/8	FRENCH	" "
◇	2'-6" x 6'-5" x 1 3/8	LOUVERED	" "
◇	2'-4" x 6'-5" x 1 3/8	SIX PANEL	" "
◇	2'-0" x 6'-5" x 1 3/8	" "	" "
◇	(2) 2'-0" x 6'-5" x 1 3/8	" "	" "
◇	10'-0" x 7'-0"	OVERHEAD GARAGE	STEEL

WINDOW SCHEDULE			
MARK	SIZE	TYPE	REMARKS
A	3'-0" x 6'-0"	SINGLE HUNG	METAL INSUL.
B	(2) 3'-0" x 6'-0"	" "	" "
C	4'-0" x 6'-0"	" "	" "
D	2'-8" x 6'-0"	" "	" "
E	3'-0" x 5'-0"	" "	" "
F	(2) 3'-0" x 5'-0"	" "	" "
G	4'-0" x 6'-0"	ARCHED / FIXED	" "
H	3'-0" x 1'-6"	TRANSOM	" "
J	2'-0" x 1'-0"	TRANSOM	" "

Claire's Home Designs 5775 Montgomery Hwy. 791-1327 A new home by: Southern Homebuilders for: The Cooley Family	MAY 2014	Heated sq. ft: 3333	<h1>203 Shandwick Ct.</h1>
	Plan no. 1409-MTC	Unheated sq. ft: 1098	